

See page 3 for air release components

See page 7 for special order topplate options

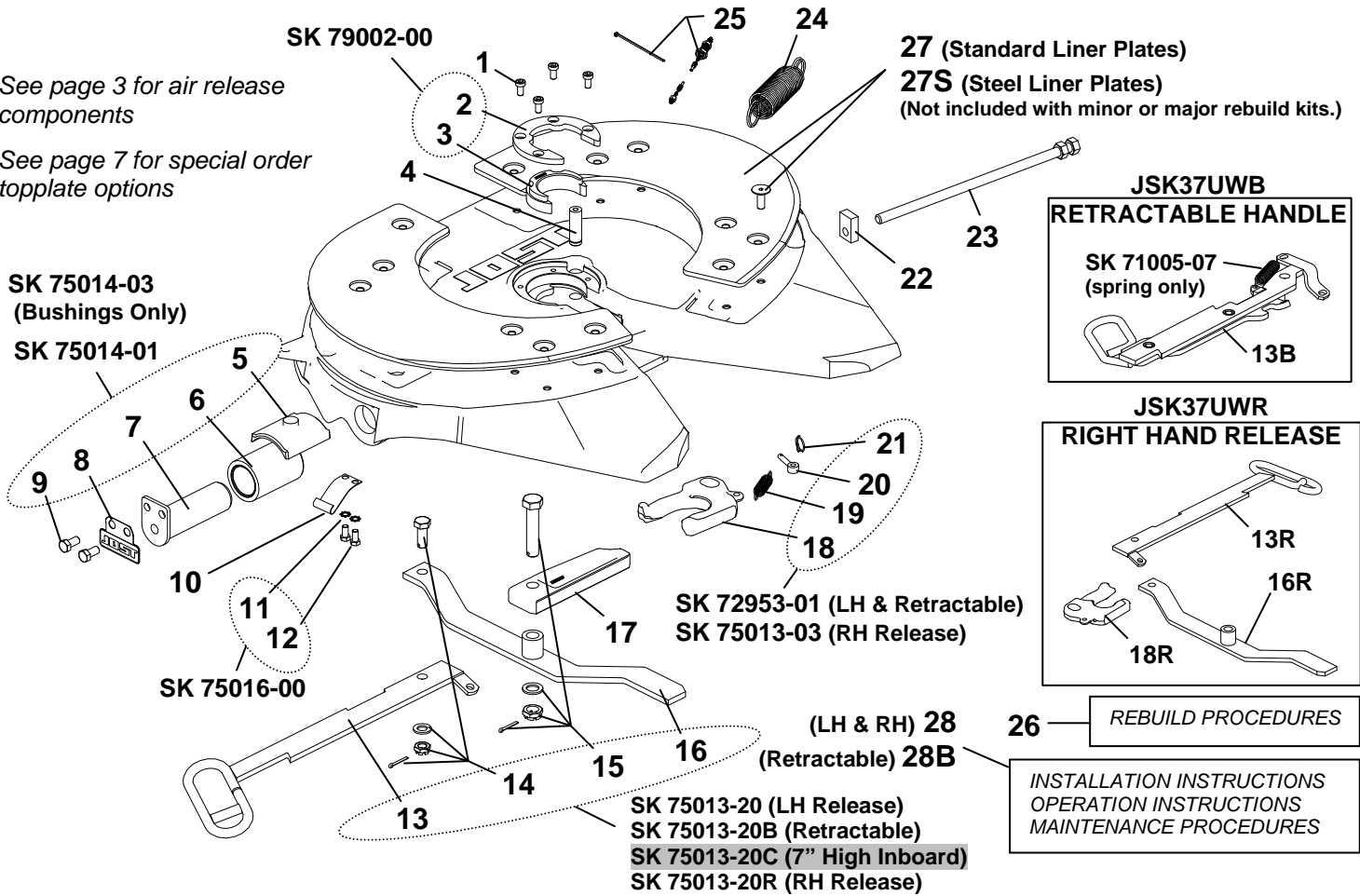

Item	Description	Part No.	Item	Description	Part No.
1	Cushion ring bolt	SK 73121-55	16	LH Lever with bushing	SK 3105-140
2	Retainer	SK 3105-93	16C	LH Lever – 7" high inboard	SK 79003-00
3	Cushion ring insert	SK 3105-92	16R	RH Lever with bushing	SK 3105-18
4	Lock jaw pivot pin	SK 72106-67	17	Locking bar	SK 3205-06
5	Collar	SK 3105-95	18	LH Lock jaw	SK 1489LZ
6	Bushing	SK 2905-94	18R	RH Lock jaw	SK 1489Z
7	Bracket pin – Ø50mm	SK 79011-03	19	Lock jaw spring	SK 847
8	Tab washer	SK 73104-47	20	Eye bolt	SK 2106-69
9	1/2-13 x 3/4 lg. Hex bolt	SK 70202-15	21	Ring	SK 2106-70
10	Plate spring	SK 70993-00	22	Guide piece	SK 73205-07
11	External tooth lock washer	SK 70301-00	23	Adjusting screw with hex nut	SK 3105-151
12	Hex bolt	SK 73121-28B	24	Double tension spring	SK 3105-20
13	LH Release handle	SK 73105-15	25	Lubricating kit	SK 3108-02
13B	Retractable Handle w/spring	SK 75016-04	26	Rebuild Procedures	LT JSK37-03
13R	RH Release handle	SK 79009-27	27	Liner plates & Bolts (Standard)	SK 3106-003
14	Pivot bolt assembly	SK 71513	27S	Liner plates & Bolts (Steel)	SK 79004-01
15	Locking bar bolt assembly	SK 73221-01	28	Info Pack (LH & RH)	SK 75020-02
			28B	Info Pack (Retractable)	SK 75020-11

Major Rebuild Kit			Minor Rebuild Kit (see pg. 34)	
Complete Rebuild Kit			Cushion and Lock Jaw	
Includes Items 1-26 above			Includes Items 1-4, 18-21 & 25 above	
Model number	JOIST Order Number	Weight	JOIST Order Number	Weight
37UWB	SK 75013-09	35 lbs.	SK 73221-50Z	6 lbs.
37UWL	SK 75013-00	33 lbs.		
37UWR	SK 75013-01	33 lbs.		

*See part number master on page 1 for complete part number options.