

DIS-ASSEMBLY INSTRUCTIONS:

1. Remove topplate assembly.
 - a. Bend over locking tabs.
 - b. Remove screws securing pins.
 - c. Pull pins from casting.
 - d. Lift the topplate.
Use caution when lifting, it is heavy!

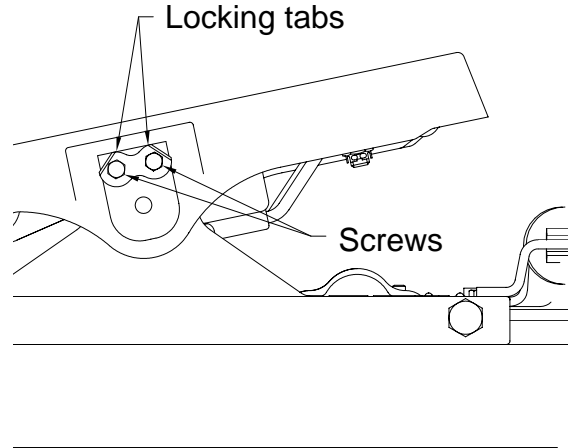

Figure 1

2. Remove rear stop and cross member (item 1 Figure 2).
3. Energize air cylinder, and then remove slide bracket.
4. Remove front stop and cross member (item 2 Figure 2).

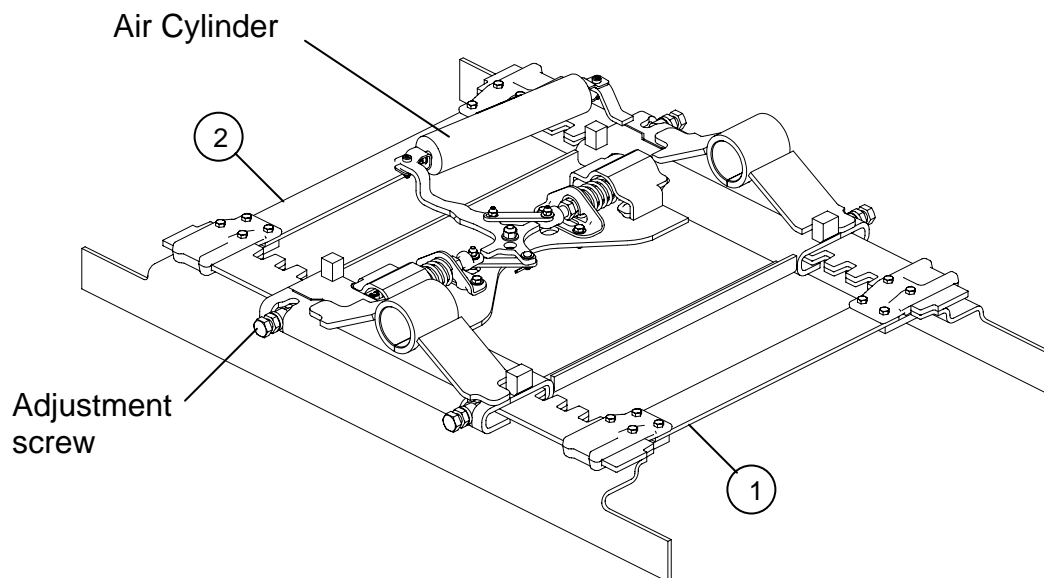

Figure 2

ASSEMBLY INSTRUCTIONS:

1. Attach the mounting angles making sure that they sit flush against the tractor frame.

Note: It is important that the angles are square across the frame to assure that the slide bracket will slide freely and the locking plungers will engage completely.

2. Energize the air cylinder and attempt to slide the bracket onto the mounting angles. If there appears to be interference loosen all 4-adjustment screws, 4 turns.
3. After sliding the bracket into position tighten each pair of adjustment screws one turn at a time until both sides are in contact with the mounting angle.
4. Now, loosen each pair of adjustment screws 1/2 turn and set the jam nut.
5. Energize the air cylinder and slide the bracket fore-and-aft making sure the slider moves freely. Loosen or tighten the adjustment screws as required.
6. Install the front and rear stops and cross members. Install Loctite® on each fastener and torque to 40 ft-lbs.
7. Check for proper operation. Slide the fifth wheel fore-and-aft and check for proper locking. When properly locked the locking mechanism must in a horizontal position, and the air cylinder must be fully retracted (see Figure 3).

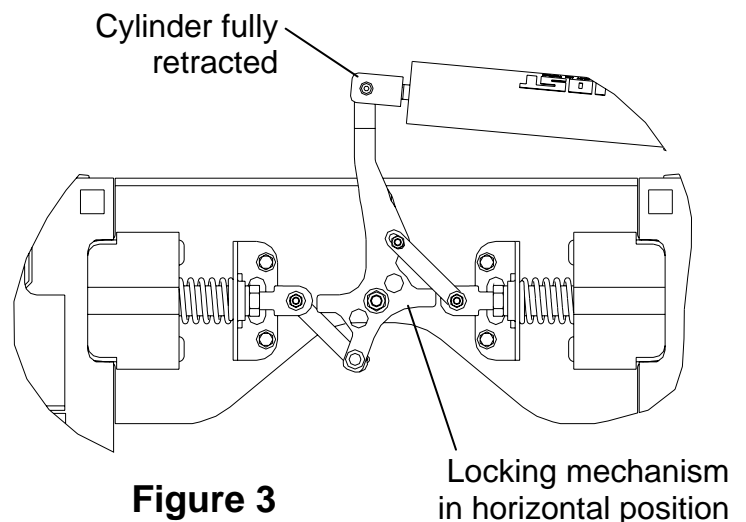

8. If the locking mechanism does not fully close it is necessary to re-adjust the plungers. If this is necessary proceed as follows:
 - a. Remove the pivot bolts.
 - b. Loosen jam nuts and loosen or tighten both adjustment knuckles evenly until the pivot bolts removed can be easily inserted through the pivot holes with the locking mechanism in the closed position.
 - c. Now set the adjustment by tightening both jam nuts.
 - d. Apply Loctite® to each pivot bolt, and then re-assemble the pivot bolts and nuts, removed in step “a” above, and tighten securely.

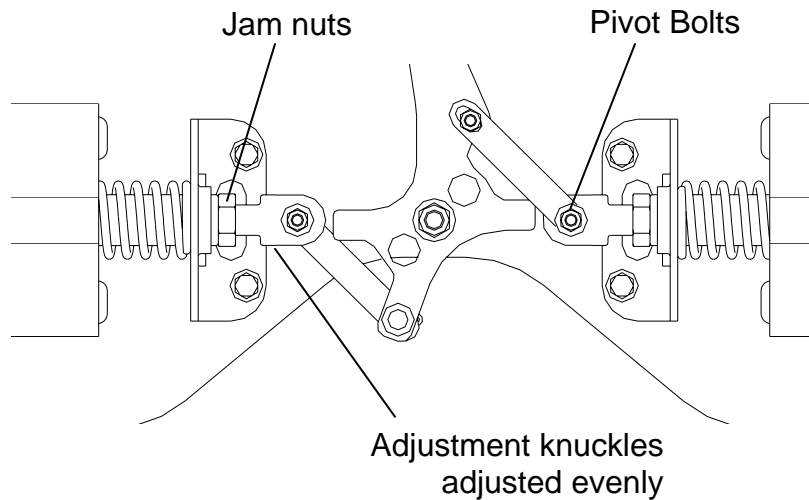

Figure 4

9. Install the topllate assembly removed in step #1 above sure to secure the locking tabs as shown in Figure 1.